

Sitting Scarecrow™

Installation and Operating Instructions

Keep all plastic and wire parts away from children.

PARTS

1. BOWL
2. POLE
3. HEAD WITH CLOTHES & BASE
4. 6V2A ADAPTER

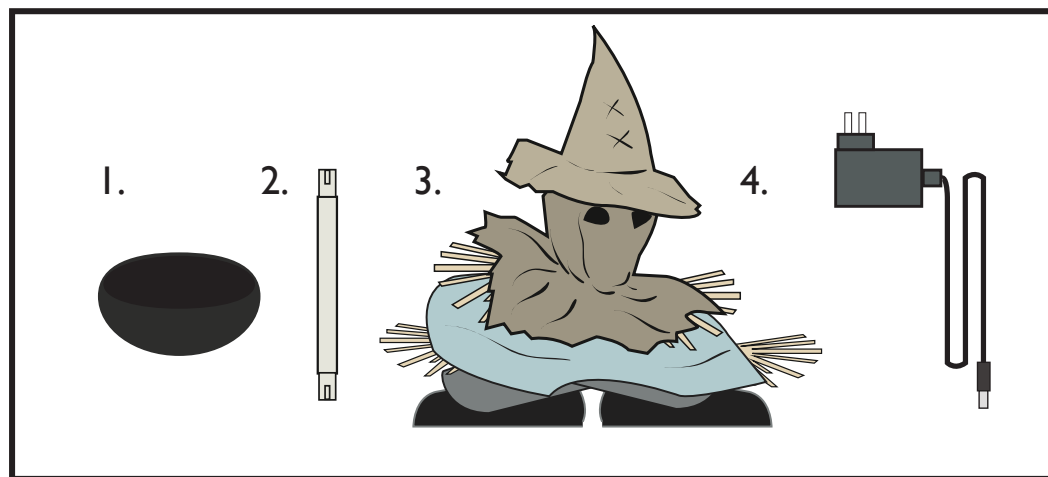

1. Open the zipper located under the back of Sitting Scarecrow's pants and insert POLE into back of HEAD WITH CLOTHES & BASE. Snap lock the POLE into the base of the neck. (Match A to A) Press POLE until it clicks into place. Insert POLE into BASE. (Match B to B) Press until it clicks into place.
2. Connect wires located on BASE to wire located on BOWL. (Match C to C)
3. Attach hook and loop fasteners on BOWL to hook and loop fasteners located on the pants.
* Note: Bowl must be level for the item to function optimally.
4. Connect 6V2A ADAPTER (included) or insert 4 AA alkaline batteries into the battery compartment located on the BASE.
5. Turn the switch to the ON position to operate in Sound and Motion activation mode. Any sound or motion inside the candy bowl will activate the item. For MOTION ONLY, only motion inside the candy bowl will activate the item. Turn item OFF when not in use. Adjust volume control knob as needed.
6. Close zipper on the back of the Scarecrow's pants. Position the Scarecrow in chair(not included), and fill BOWL to lure Trick Or Treaters for a scary surprise!

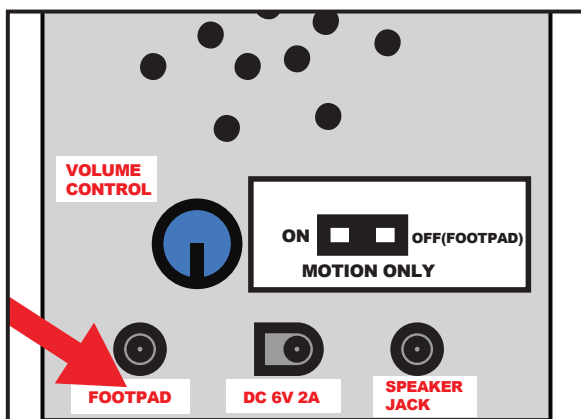
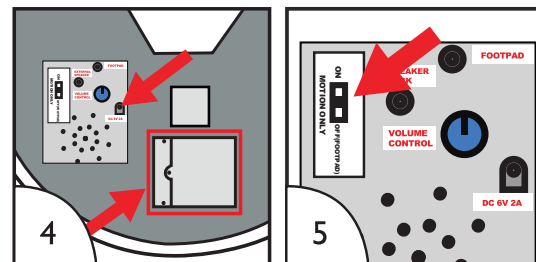
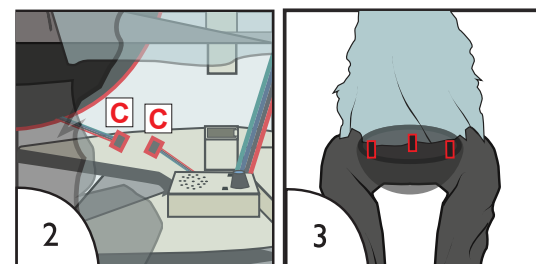
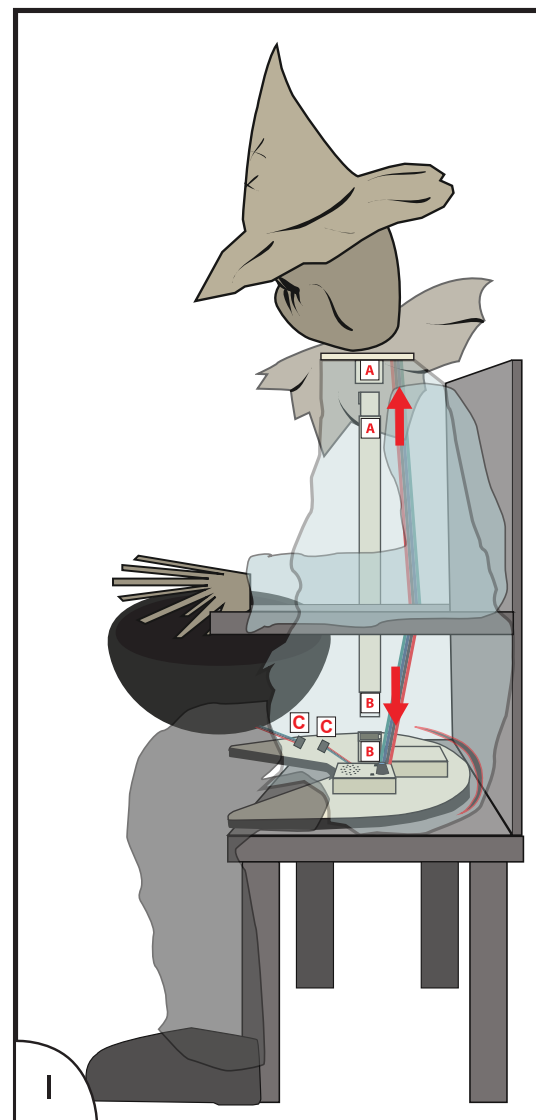

Optional Footpad Setup

Follow steps #1 through 5 on initial installation first.

1. Connect the cable from the optional footpad to the jack labeled FOOTPAD located on the BASE.
2. Place the switch on the BASE into the 'FOOTPAD' position to enable FOOTPAD activation.
3. Step on FOOTPAD to activate the scary sequence.

(go to instruction #6 to complete setup)

*Footpads are sold separately and can be purchased at www.spirithalloween.com

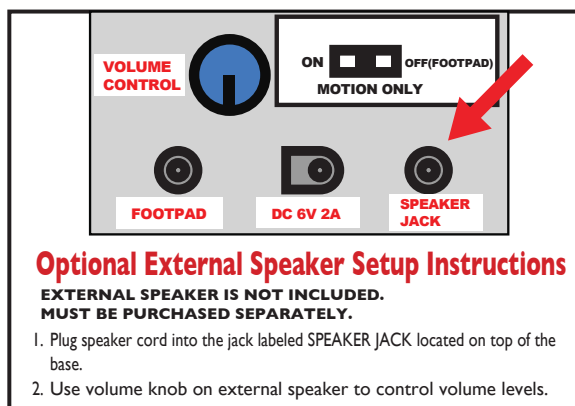

Optional External Speaker Setup Instructions

EXTERNAL SPEAKER IS NOT INCLUDED. MUST BE PURCHASED SEPARATELY.

1. Plug speaker cord into the jack labeled SPEAKER JACK located on top of the base.
2. Use volume knob on external speaker to control volume levels.

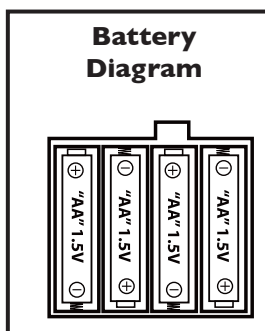

Battery Instructions and Cautions

• Use only the batteries recommended by the manufacturer. • Remove batteries when not in use. • Do NOT use rechargeable batteries. • Be sure to insert the batteries with the correct polarity +/- . • Never mix different types of batteries: old and new, carbon-zinc, alkaline, nickel-cadmium or rechargeable. • Always dispose of exhausted batteries properly. Do NOT dispose of batteries in fire, they may leak or explode. ADULT SUPERVISION RECOMMENDED WHEN CHANGING BATTERIES.

Warning! This item is not a toy. For decoration only. Small parts, choking hazard. This product is intended for use by persons 15 years of age and older. Not intended for use by children ages 14 and under.

WARNING
DO NOT TURN ITEM ON UNTIL YOU HAVE COMPLETELY FINISHED ASSEMBLY. STAY CLEAR OF ITEM WHILE OPERATING. DO NOT PLACE ITEM ON UNEVEN GROUND. DO NOT PLACE WEIGHT ON ITEM WHILE IN OPERATION. **FOR INDOOR OR SHELTERED OUTDOOR USE ONLY**

Outdoor Warning

For best overall performance, we recommend you operate your item in a sheltered outdoor area. We also recommend you bring your item indoors during adverse weather conditions (extreme cold, strong winds and/or rain). This item operates best outdoors in temperatures above freezing (32°F).

DO NOT RETURN THIS ITEM TO THE STORE!

If experiencing technical difficulties, please email: JackTheReaper@spirithalloween.com, or call 1-866-586-0155, or go to SpiritHalloween.com for assistance.

Trouble Shooting Steps

- Make sure that the BOWL wire is connected to BASE and that the BOWL is facing forward – sensor on BOWL must be facing forward to work in MOTION ONLY.
- When using motion sensor to activate – there must be enough light on the sensor (located on the front of the bowl) so that a shadow is cast over it when a person reaches for candy inside the BOWL.
- You can only use batteries OR an adapter. Not both at the same time.
- The item must be sitting level to function optimally.
- Make sure Burlap around neck is not caught in module.



SPIRITHALLOWEEN.COM

Distributed by
Spirit Halloween
6826 Black Horse Pike
Egg Harbor Township, NJ
08234-4197
MADE IN CHINA